

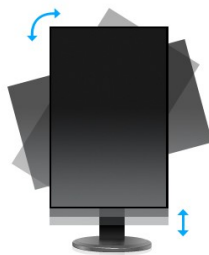

The ProLite B2480HS is a high specification 24" Full HD 1920 x 1080p LED-backlit monitor with Height Adjustability and Screen Rotation allowing you to set the perfect position of the screen ensuring ergonomic posture and optimal viewing comfort. 1msec response time and 12 000 000 : 1 Advanced Contrast Ratio make the B2480HS ideal for Video Conferencing, DTP and CAD as well as the usual text based applications. Triple Input support of Analogue, DVI and HDMI ensures compatibility with the latest installed graphics cards and embedded Notebook outputs. The monitor is TCO Certified.



### HAS + PIVOT

With a height adjustable stand you will create an ergonomic work posture and position that meets all health and safety requirements. This will not only prevent any health issues but will also increase your productivity. The pivot function allows the screen to rotate from landscape to portrait orientation. This functionality can be useful if the application requires more height than width.



### OVERDRIVE ON / OFF

When very fast graphics are displayed your monitor can sometimes get blurry. Turning on the OverDrive feature will eliminate that.

## 1. DISPLAY CHARACTERISTICS

DIAGONAL

23.6"; 60 cm

|                    |   |
|--------------------|---|
| ASPECT RATIO       | 16 : 9  |
| PANEL              | TN LED, matte finish  |
| NATIVE RESOLUTION  | Full HD 1080p, 1920 x 1080 ( 2.1 megapixel)                                   |
| BRIGHTNESS         | 250 cd/m <sup>2</sup> typical   |
| CONTRAST           | 1000 : 1 typical  |
| CONTRAST           | 12 000 000 : 1 ACR  |
| RESPONSE TIME      | 1 ms  |
| VIEWING ZONE       | horizontal/vertical: 170° / 160° ; right/left: 85° / 85° ; up/down: 80° / 80° |
| DISPLAY COLOUR     | 16.7 million  |
| BLUE LIGHT REDUCER | yes   |
| DISPLAY AREA H X W | 293.22 x 521.28 mm; 11.5" x 20.5"   |
| PIXEL PITCH H X V  | 0.2715 x 0.2715 mm  |
| HORIZONTAL SYNC    | 24 - 80 KHz   |
| VERTICAL SYNC      | 56 - 75 Hz  |
| SYNCHRONIZATION    | Separate sync   |

## 2. INTERFACES CONNECTORS

|                         |             |
|-------------------------|-------------|
| ANALOG INPUT CONNECTOR  | VGA         |
| DIGITAL INPUT CONNECTOR | DVI-D, HDMI |
| HDCP                    | yes;        |

## 3. SPECIAL FEATURES

|                           |   |
|---------------------------|---|
| APPLE - MAC               | All iiyama monitors are compatible with Apple-Macintosh computers.  |
| PLUG & PLAY               | VESA DDC2B™   |
| CONTROLS                  | Via OSD in 9 languages (EN, DE, FR, ES, IT, PT, Chinese, RU, JP) and 5 front controls (Power, Menu, +/- Volume, -/ ECO, Auto)   |
| USER CONTROLS             | luminance (contrast, brightness, ECO, i-style Colour, ACR), image steep (clock, phase, H. position, V. position, aspect), colour (gamma, colour temperature, sRGB), OSD setup (H. position, V. position, OSD time out, language), others (reset, signal select, HDMI audio, OD, information), volume, auto adjust |
| SPEAKERS                  | 2 x 2 W (Stereo)  |
| ANTI-THEFT-DEVICE         | Kensington-lock™ prepared   |
| ERGONOMICS                | CE, TUV-GS, CU, TCO 6   |
| HEIGHT ADJUSTABLE STAND   | Yes   |
| HEIGHT ADJUSTMENT         | 130 mm  |
| ROTATION (PIVOT FUNCTION) | 90°   |
| SWIVEL STAND              | 320°; 160° left; 160° right   |
| TILT ANGLE                | 22° up; 5° down   |
| VESA MOUNTING             | 100 x 100 mm  |

## 4. ACCESSORIES

|                      |  |
|----------------------|--|
| INCLUDED ACCESSORIES | power cable, DVI-D cable, audio cable, stand, screw, cable holder, quick start guide, safety guide |
|----------------------|--|

## 5. POWER MANAGEMENT

|                   |   |
|-------------------|---|
| POWER SUPPLY      | AC100~240V 50/60Hz                                |
| POWER SUPPLY UNIT | internal  |
| POWER USAGE       | 22 W typical; max. 0.5 W in Power management mode |
| POWER MANAGEMENT  | VESA DPMS   |

## 6.

## 7. EPEAT SILVER

EPEAT

EPEAT is a comprehensive environmental rating that helps identify greener computers and other electronic equipment. The Silver certification means the monitor meets all required criteria plus at least 50% of the optional requirements. EPEAT Silver is valid in countries where iiyama registers the product. Please visit [www.epeat.net](http://www.epeat.net) for the registration status in your country.

## 8. DIMENSIONS & WEIGHT

|                      |                              |
|----------------------|------------------------------|
| DIMENSIONS W X H X D | 571.5 x 427 (557) x 244.5 mm |
| WEIGHT               | 6.1 kg                       |

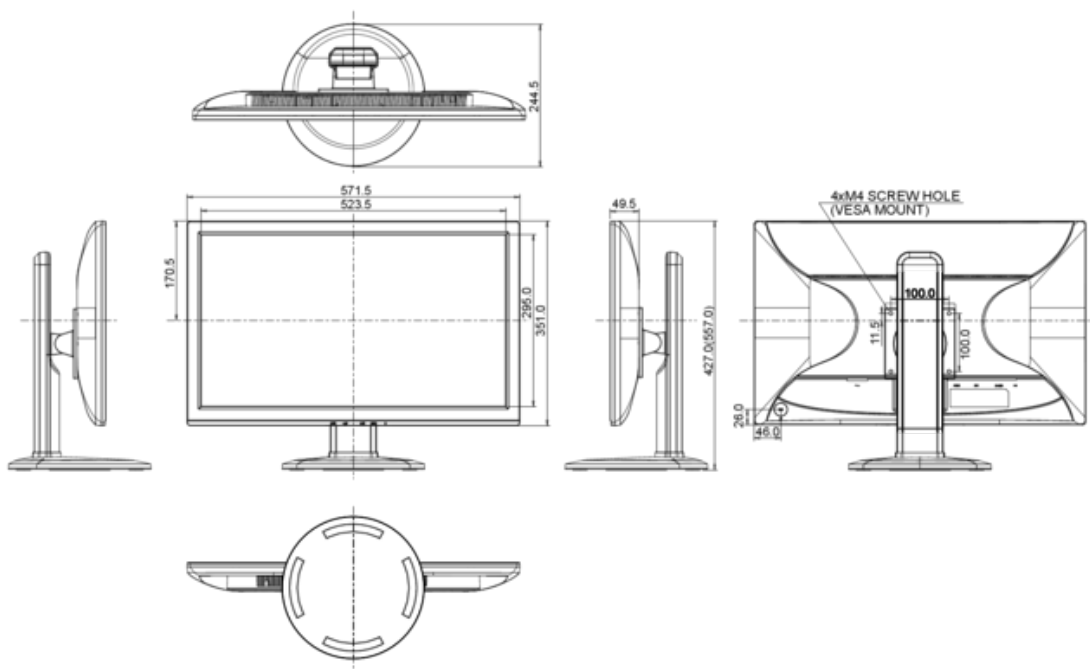

*All trademarks and registered trademarks acknowledged. E & O E. Specification subject to change without notice. All LCD's comply with ISO-9241-307:2008 in connection with pixel defects.*

© IIYAMA CORPORATION ( ). ALL RIGHTS RESERVED.