

86" Interactive 4K UHD Touchscreen elevating interactive collaboration

The [TE8612MIS-B2AG](#) is an exceptional 4K UHD interactive display designed by iiyama to enhance collaboration, communication, and engagement. With key features like Zero Airgap LCD screen eliminating parallax, accurate PureTouch-IR, iiWare 10 with Android 11, Wifi, and the iiyama DMS (Device management System), this display transforms the way you engage with content, making it an indispensable tool for modern workspaces and educational settings.

Boasting a new 4K Interface with User Profiles for simple login and access to your very own bespoke application and Cloud Drives or harmonize with your existing estate and unleash the true power of Windows and Office applications. iiyama [TE8612MIS-B2AG](#) becomes a highly personalised & flexible device within a busy hybrid environment for multiple users.

Share wirelessly more easily than ever before with iiyama Share and [EShare](#) app, bringing effortless ideation and efficient collaboration in your enterprise or school. This affordable display transforms the modern workplaces, educational institutions, dynamic meeting spaces and beyond. Elevate your interactive experience with the iiyama TE12 SERIES displays and embrace the future of visual communication.



PureTouch-IR

PureTouch-IR from iiyama delivers 1mm touch accuracy for the smoothest and fastest annotation.



iiWare

iiWare 10 features Note, Browser, Cloud Drive and the option for you to sideload relevant apps you require for your organisation.

01 DISPLAY CHARACTERISTICS

Design	Thin bezel
Diagonal	85.6", 217.4cm
Panel	VA, haze haze 25%
Touch Glass	AG coated glass, zero air-gap
Native resolution	3840 x 2160 (8.3 megapixel 4K UHD)
Aspect ratio	16:9
Panel brightness	400 cd/m ²
Light transmittance	92%
Static contrast	4000:1
Dynamic contrast	8000:1
Response time (GTG)	8ms
Viewing zone	horizontal/vertical: horizontal°/vertical 178°, right/left: 0°/0°, up/down: 0°/0°
Colour support	1.07B 8bit+FRC
Horizontal Sync	30 - 135kHz
Viewable area W x H	1895 x 1066mm, 74.6 x 42"
Bezel width (sides, top, bottom)	16.5mm, 16.5mm, 30mm
Pixel pitch	0.4935mm
Bezel colour and finish	black, matte

02 TOUCH

Touch technology	PureTouch-IR
Touch points	40 (5pt writing, HID, only with supported OS)
Touch accuracy	+/- 1.5mm
Touch method	stylus, finger, glove
Touch interface	USB
Supported operating systems	All iiyama monitors are Plug & Play and compatible with Windows and Linux. For details regarding the supported OS for the touch models, please refer to the driver instruction file available in the downloads section.

03 INTERFACES / CONNECTORS / CONTROLS

Analog signal input	VGA x1 (max. 1920x1080 @60Hz)
Digital signal input	HDMI x3 (v.2.0, max. 3840x2160 @60Hz, YUV444) USB-C x1 (v.3.2 (Gen 1, 5Gbit), 3840x2160 @60Hz - RGB444 - (65W charging, Touch)
Audio input	Mini jack x1
Monitor control input	RS-232c x1 (DSUB 9pin) RJ45 (LAN) x1 (LAN Control) IR x1
Digital signal output	HDMI x1 (3840x2160 @60Hz)
Audio output	S/PDIF (Optical) x1 Mini jack x1 Speakers 2 x 16W (Front)
HDCP	HDMI 1: 2.1, USB-C: 2.2
USB ports	x5 (media playback / peripherals / storage – front side: 2x v.3.2 (Gen 1, 5Gbit), 1x USB-C v.3.2 (Gen 1, 5Gbit, 65W PD), right side: 2x v.3.2 (Gen 1, 5Gbit))
RJ45 (LAN)	x2 (Auto switch for PC & Android, 1000MB)

04 FEATURES

Integrated software	iiWare 10 (Android 11 OS) featuring iiyama DMS, Note, web browser, file manager, cloud drives, WPS office, iiyama Share and EShare for wireless connection with Windows/iOS/Android devices
WiFi	yes (WiFi 6 Module OWM002 - Dual WiFi Bandwidth: 2.4GHz/5GHz, WiFi Standard: IEEE 802.11 a/b/g/n/ac, Bluetooth Support: 2.1/3.0/4.2/5.0)
Hardware	Quad core A55 CPU, Mali G52 GPU, 4GB RAM, 32GB internal memory
Extra	WiFi 6 Module (OWM002), Slot for optional OPS Slot PC, 4x Touch pen
Kiosk mode	yes
Max. non-stop operating time	24/7
Media playback	yes
Glass thickness	3mm
Glass hardness	7H
Housing (bezel)	metal
OSD key lock	yes

05 GENERAL

OSD languages	EN, DE, FR, ES, IT, RU, CZ, NL, PL, SV, FI, DA, NB
Control buttons	Power, Power Indicator, Remote Sensor, Light Sensor
User controls	general settings (input, volume, backlight), audio settings (volume, bass, treble, balance, sound mode, mute), screen settings (aspect ratio, pixel shift), display settings (brightness, contrast, hue, sharpness, display mode, colour temp.), adjust settings (H-position, V-position, clock, phase, auto), settings (wireless & networks, personal, input & output, application, system)
Blue light reducer	yes
Plug&Play	DDC2B
Warranty	5 years (for details and eligible countries please check the Warranty section of our website)

06 MECHANICAL

Orientation	landscape
Fanless design	yes
VESA mounting	800 x 600mm
Operation temperature range	0°C - 40°C
Storage temperature range	- 20°C - +2°C
MTBF	50.000 hours (excluding backlight)

07 ACCESSORIES INCLUDED

Cables	power, USB, HDMI
Touch pen	x4 (Dual function tips)
Guides	quick start guide, safety guide
Other	WiFi 6 Module (OWM002), Mounting bracket for NUC, Mounting bracket for webcam
Remote control	yes (batteries included)

08 POWER MANAGEMENT

Power supply unit	internal
-------------------	----------

Power supply	AC AC - 100V, 240/V, 50Hz
Power usage	222W typical, 0.5W stand by, 0.3W off mode

09 SUSTAINABILITY

Regulations	CB, CE, TÜV-Bauart, EAC, RoHS support, ErP, WEEE, REACH (RoHS)
REACH SVHC	above 0.1%: Lead

10 DIMENSIONS / WEIGHT

Product dimensions W x H x D	1957 x 1160 x 100mm
Box dimensions W x H x D	2110 x 1283 x 225mm
Weight (without box)	58.6kg
Weight (with box)	75.9kg
EAN code	4948570122967

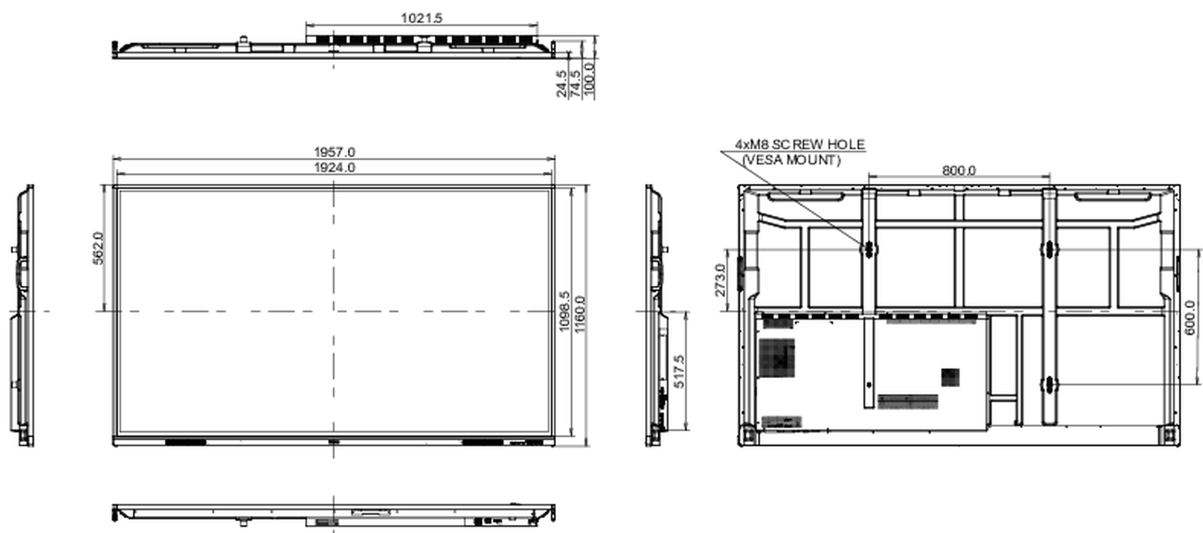

All trademarks and registered trademarks acknowledged. E & O E. Specification subject to change without notice. All LCD's comply with ISO-9241-307:2008 in connection with pixel defects.

© IIYAMA CORPORATION. ALL RIGHTS RESERVED